



Emphasis in Themed Environments

Focusing on themed environments, the curriculum addresses industry standards and skills related to a narrative-driven built environment. Courses focus on building a knowledge of three-dimensional spatial relationships, material properties, fabrication techniques, wayfinding, and developing your digital visualization and communication techniques.

Develop Technical Skills

Entertainment Design students develop advanced technical skills using a variety of design techniques in drawing, including CAD drawing, 3D modeling, and 3D prototyping. These skills are essential for communicating visual ideas for architectural elements, spatial design, signage, and more.



Entertainment Design

Translating stories into experiences.

Entertainment Design is the art of creating compelling and engaging experiences for entertainment. Entertainment is rooted in story, and the skill of the Entertainment Designer is to effectively and collaboratively translate a narrative, concept, or theme into a real-world experience that resonates with the guest.

As a student of this program, you will learn the skills necessary to conceive, visualize, and realize innovative design solutions that bring immersive entertainment experiences to life. You will work across disciplines to design for theme parks and destinations, themed dining, exhibitions, and interactive experiences, to name a few.

The Entertainment Design industry is expanding worldwide. Discover how a degree in Entertainment Design from Ringling College of Art and Design can take you to new places—both around the globe and into worlds that have yet to be built.

Career Options

Attractions Designer	In-Show Graphics Designer
CAD Designer	Museum Exhibit Designer
Color Designer	Production Show Set Designer
Concept Designer	Set Decorator
Creative Services Project Manager	Sets & Scenic Designer
Exhibit Content Developer	Signage Designer
Exhibit Designer	Themed Entertainment Creator
Experience Design Manager	
Hospitality Designer	



Faculty

Our faculty is composed of artists and designers who are passionate about the world of entertainment design and have years of experience working in the industry.

Learn more about our faculty:
www.ringling.edu/faculty

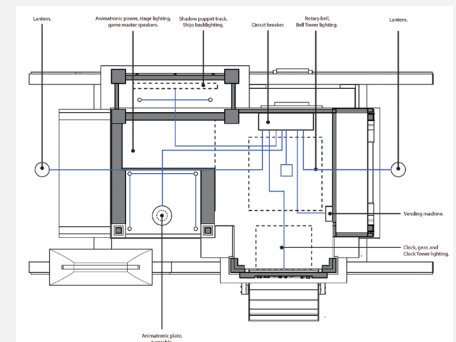
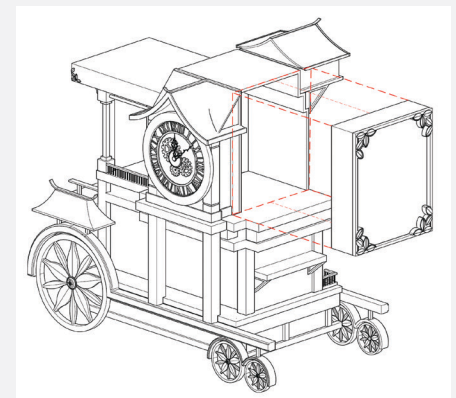
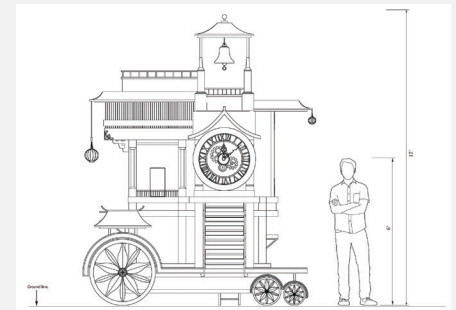

Themed Entertainment Association (TEA)

Ringling College is a member of the industry's major organization, the Themed Entertainment Association (TEA), which is a network of the world's leading creators, developers, designers, and producers of compelling places and experiences. Our students organized a student chapter so graduates of the program that are members can use this network to pursue opportunities in the industry such as internships and jobs, as well as have access to professional development resources like webinars, conferences, and behind-the-scenes events.

Project Emphasis on Themed Environments

Your design knowledge and technical skills are applied to projects in areas such as:

- Themed Environments including Theme Parks and Resorts
- Cultural Destinations
- Themed Retail and Dining

Industry Examples

Themed Environments

Harry Potter World
 Atlantis
 Revenge of the Mummy
 The Simpsons Ride
 ET Adventure
 Skull Island: Reign of Kong
 Jurassic Park
 The Cat in the Hat Ride
 Spaceship Earth
 Journey into Imagination

Cultural Destinations

Meow Wolf
 Museum of Ice Cream
 Kidzania
 St. Michael's Mystery, Prague
 National Science Center, Fort Discovery Theater
 National Geographic Grand Canyon Visitor Center
 Titanic Belfast
 I Am a Man Plaza, Memphis

Themed Retail

Tesla
 Apple Store
 Microsoft Store
 Niketown
 Madrid Xanadu
 Joy City, Shanghai
 Cadillac House Brand Experience, New York City
 Tom Ford Private Blend Experience, Dubai

Themed Restaurants

Hard Rock
 Medieval Times Dinner & Tournament
 Pirates Dinner Adventure
 Capone's Dinner & Show
 The Cirque Magique
 Mythos Restaurant, Islands of Adventure
 Three Broomsticks
 Margaritaville

On the cover: Mote Marine Aquarium
 by Blaine Zweifel '23

Top Right: Technical drawings from
The World of Aetera
 by Ally Jacobson '23