

amity
furniture for generations.



Project Statment

As the 5th anniversary gift of wood symbolizes stability in relationships, signifying strong, long-lasting bonds, Amity was designed to function as a space for families to grow these values together. It's versatility stems from the need to balance work and personal life in busy households, providing working parents an opportunity to spend time with their little ones, from infancy to childhood.

With its ability to adapt to users' needs, Amity is suited for all stages of family life. Parents are able to work alongside their children, watching them grow in a safe environment provided by Formica's antimicrobial laminates, and writable surfaces that define the play, enrichment, and working experiences tied to the piece.

From crib, to play tunnel, to a personalized office space, Amity brings stability into a family home as a centerpiece of strength and adaptability for long-lasting familial bonds to grow alongside furniture that lasts for generations.

Table of Contents

INTRODUCTION

00	Stage 1 Rendered Image
01	Project Statement
	Table of Contents

RENDERS

02	Stage 2 Rendered Image
03	Stage 3 Rendered Image

WORKING DRAWINGS

04	Material Callouts
05	Style One Breakdown
06	Style Two Breakdown
07	Piece A Dimensions
08	Piece B Dimensions
09	Piece A & B Isometrics

amity

furniture for generations.





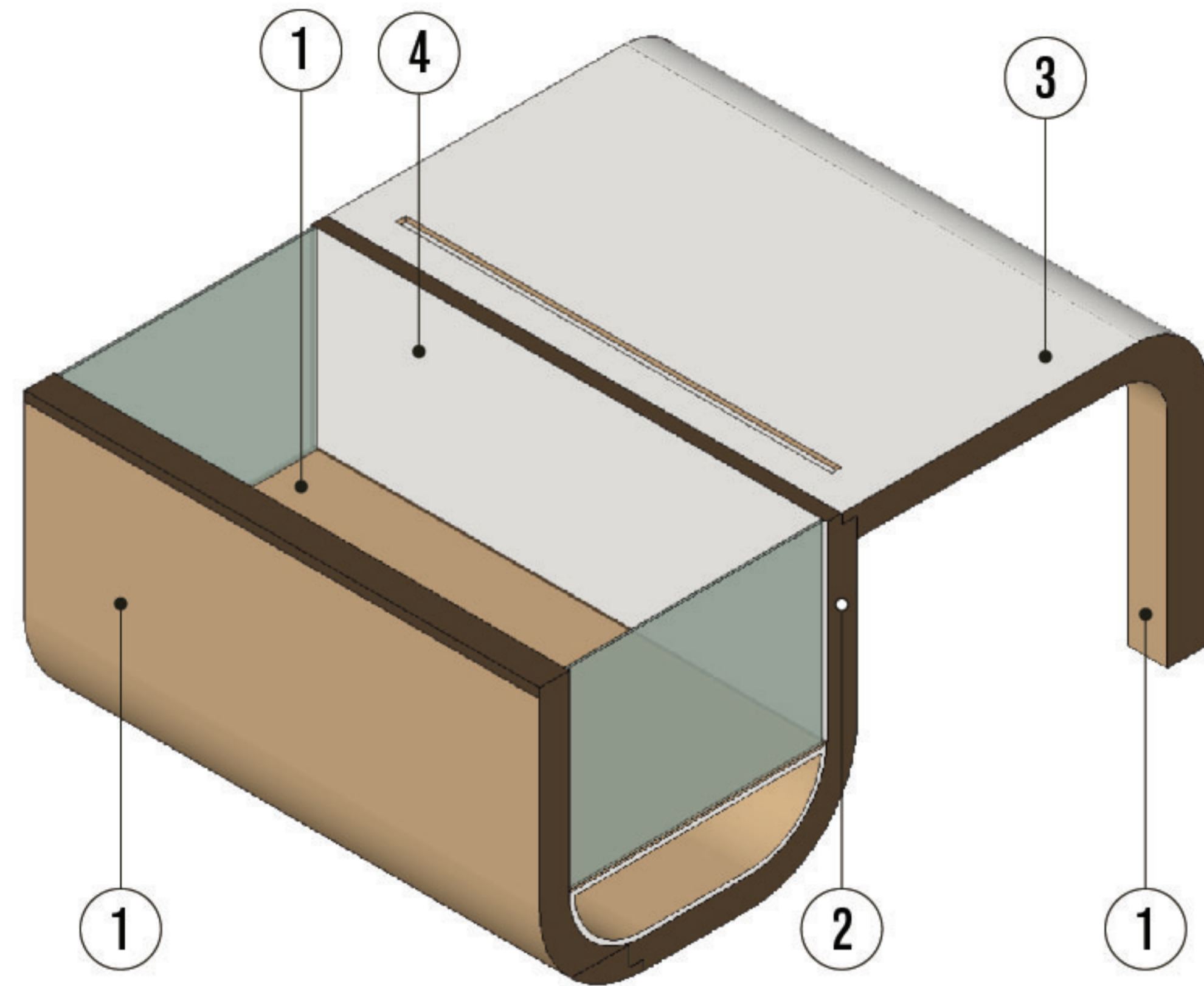

3 ISO LEFT | Attachment Style One
04 Scale: NTS

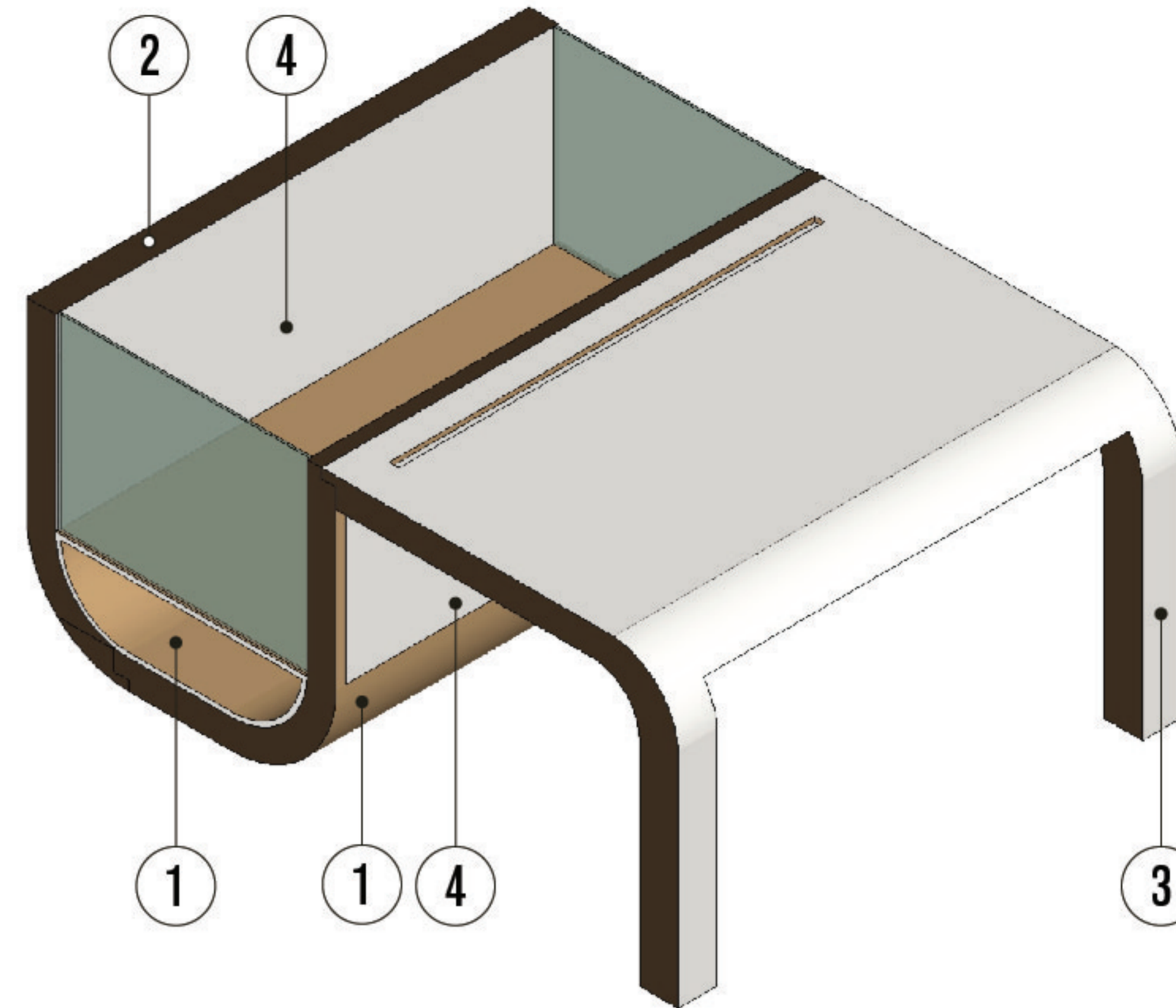

4 ISO RIGHT | Attachment Style One
04 Scale: NTS

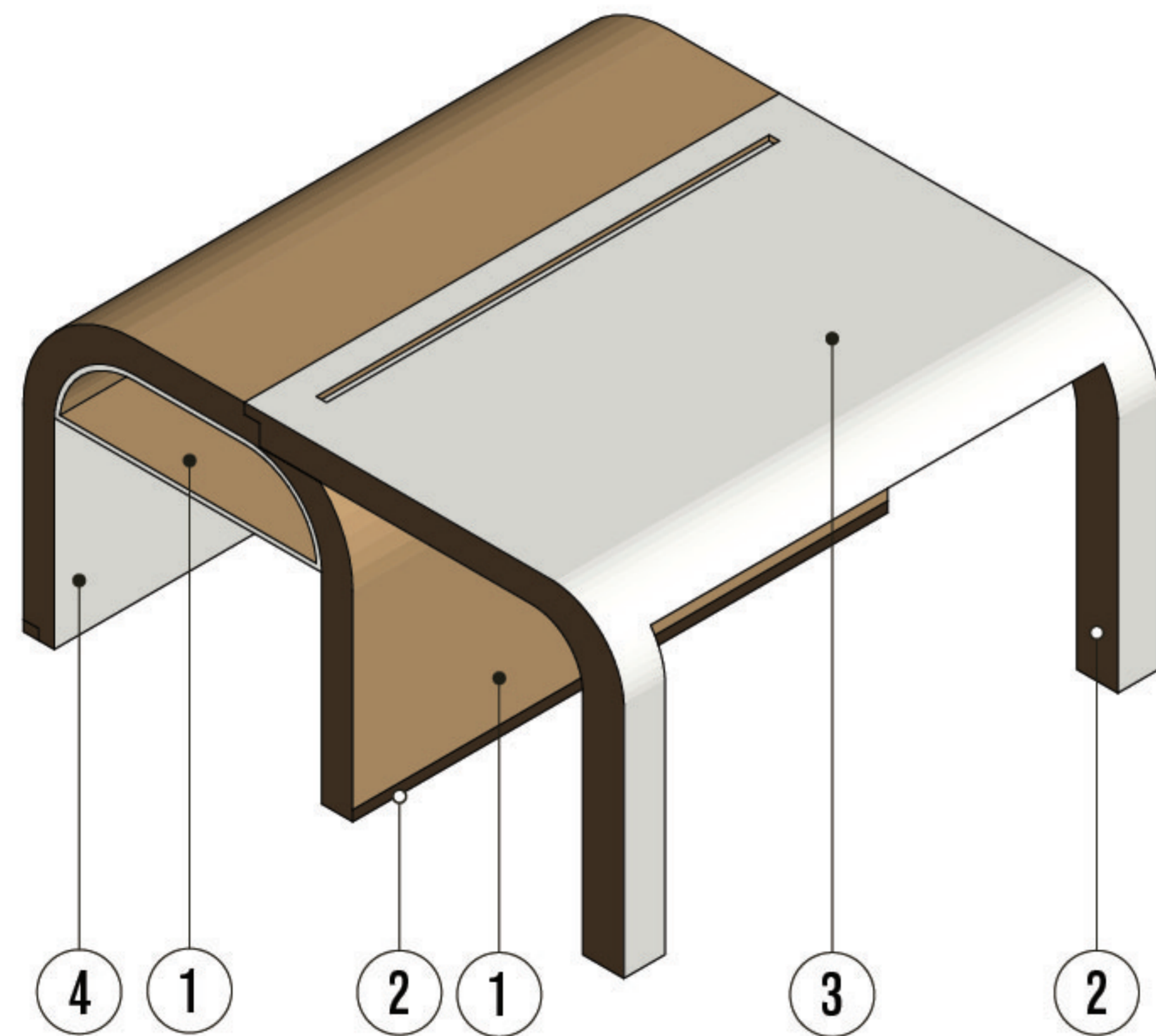

2 ISO LEFT | Attachment Style Two
04 Scale: NTS

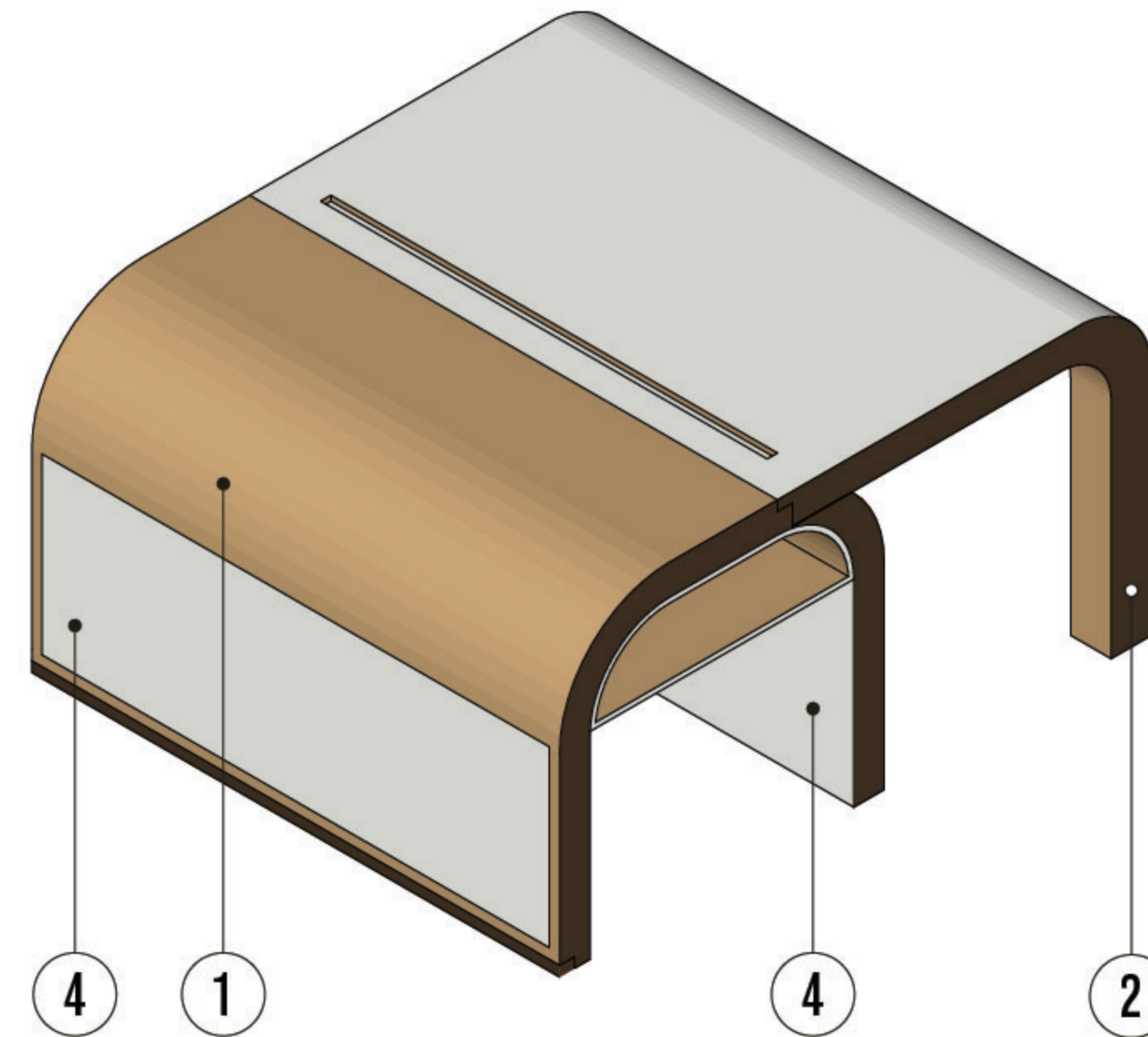

1 ISO RIGHT | Attachment Style Two
04 Scale: NTS

Notes

1. The rim of the shelf is laminated in material 3; all other interior and exterior planes are material 1, as noted.
2. The gap in the desk is laminated with material 1 on the 4 VERTICAL PLANES, and the bottom face is laminated in material 3. See page 08 for more information.
3. The underside of the desk (piece B) is laminated fully in material 1.
4. Barrier panes in Attachment Style One must be translucent for easy viewing of child in crib, and removable for tunnel access in Attachment Style Two; made from child-safe acrylic or glass.
5. Each Attachment Style can accommodate three sitting orientations at the desk; the spaces on either side next to the crib are just as important as having enough width for leg room as the bigger opening on the side.
6. Temporary fill-in pieces come with the crib element to attach and detach at will of the user, for simple switching of styles and a cleaner shape language (see pages 05 and 06 for further details).

Materials

①	Aged Ash Antimicrobial	8844A
②	Walnut Riftwood Antimicrobial	9283A
③	Dover White Antimicrobial	7197A
④	Dover White Writable Surface	7197

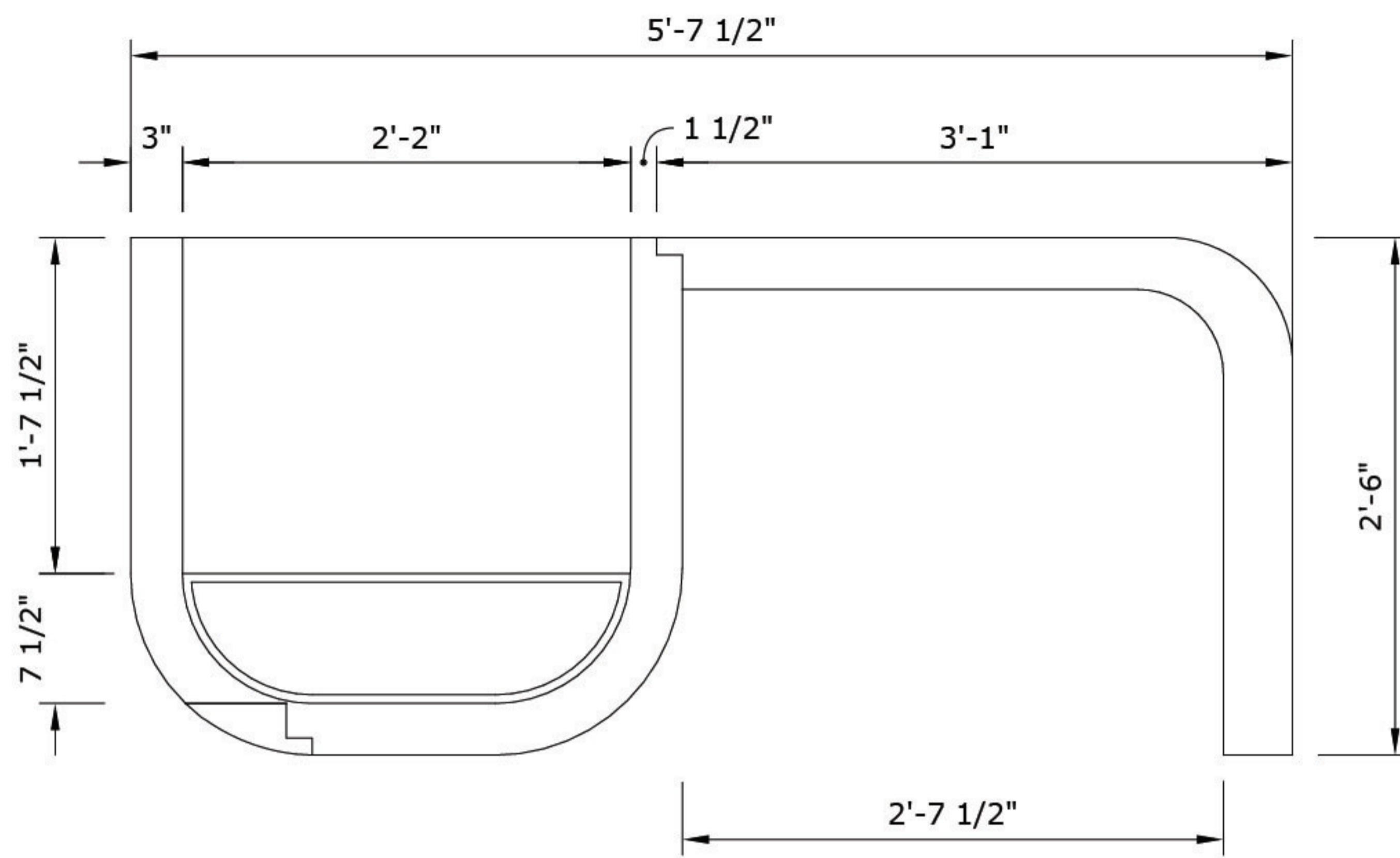

3 FRONT | Attachment Style One
05 Scale: 1" = 1'0

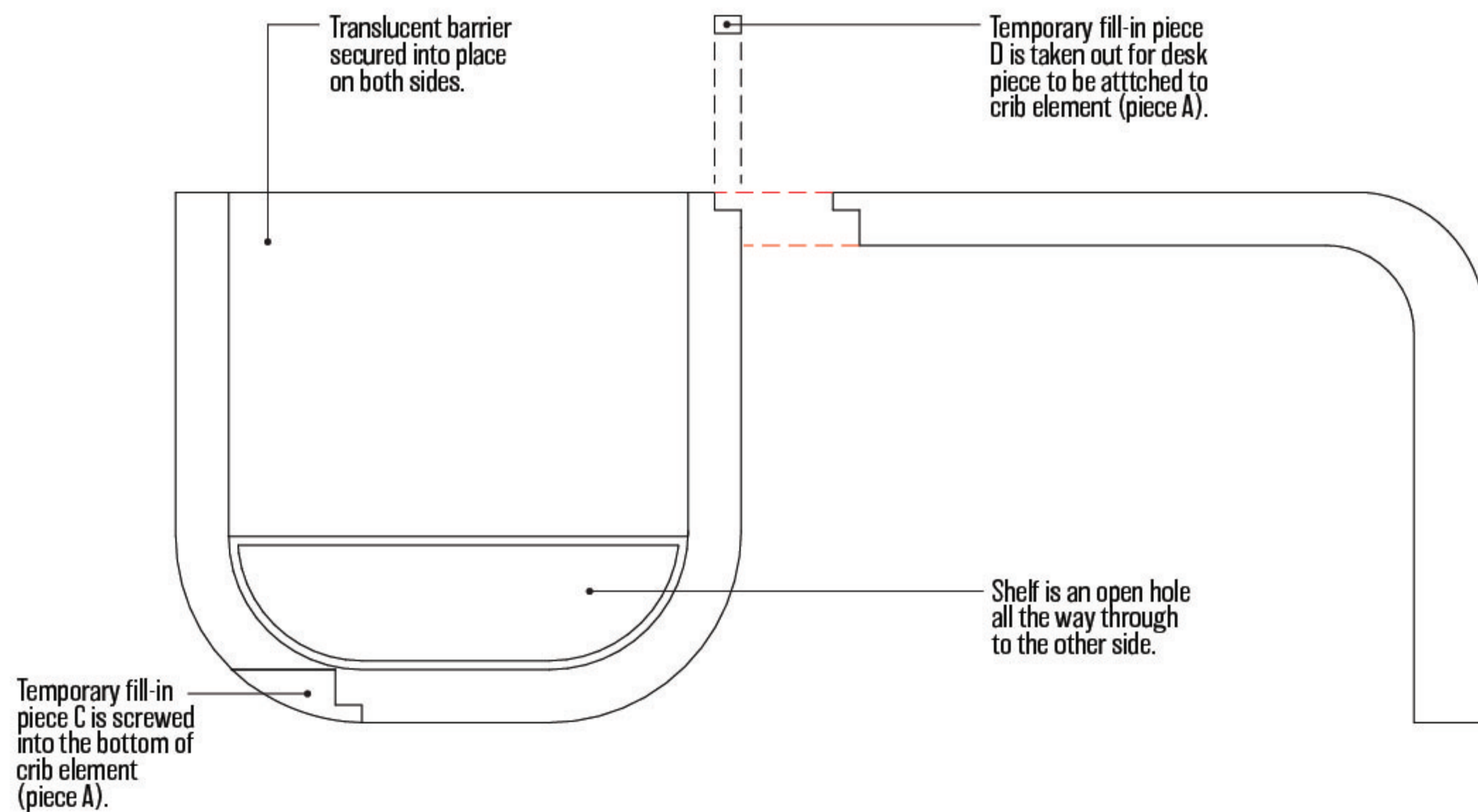

2 Attachment Style One
05 Scale: 1" = 1'0

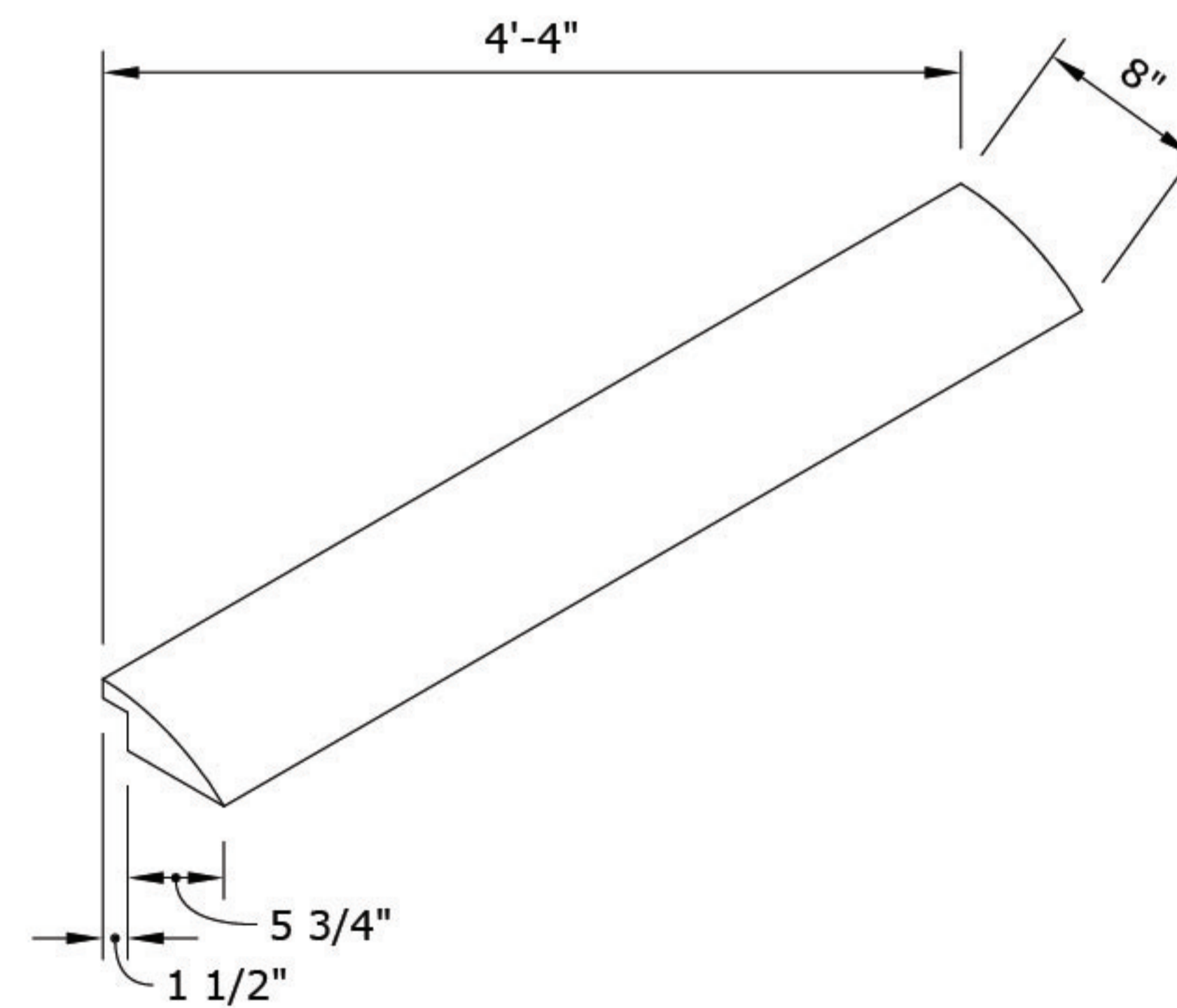

1 ISO RIGHT | Temporary Fill-In, Piece C
05 Scale: 1" = 1'0

Notes

A. Black dotted lines indicate a piece being removed. Red dotted lines indicate where pieces connect.

1. The crib is able to accommodate a standard sized mattress, and is styled in a way that will allow for other uses in this Attachment Style when there is no longer a current use for a crib (refer to rendered image on page 03).

2. Fill-in pieces will need to be securely screwed in, yet still remain removable to the user, along the length of the crib (piece A). They should NOT effect the structural integrity of the overall piece, but make up for a clean silhouette when swapping between Attachment Styles.

3. Translucent barrier panes will need to securely slide into place on either side of the crib (piece A), and still remain removeable. See page 07 for more details.

4. Fill-in pieces will have to come with predrilled holes that align with piece A for easy dis/assembly.

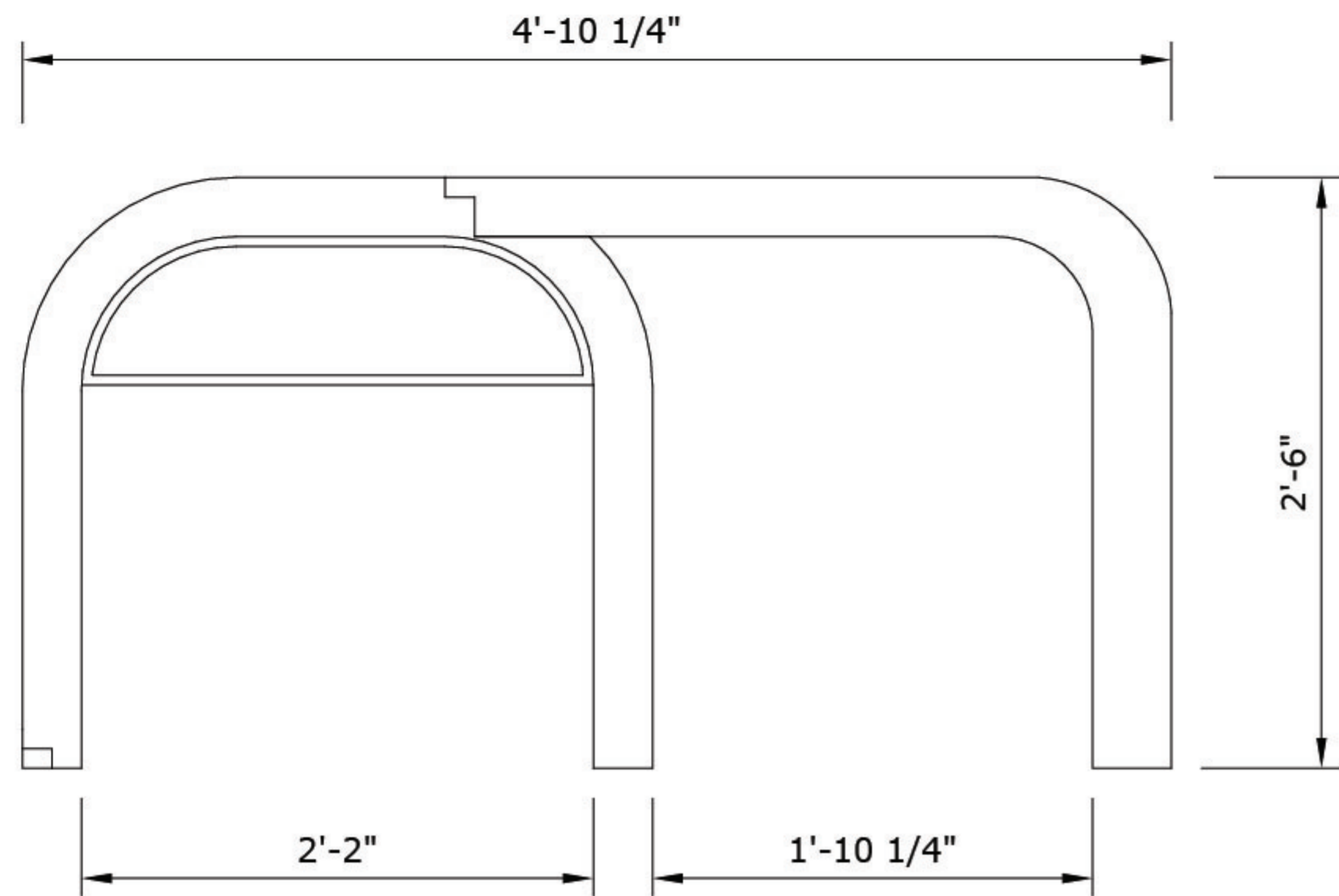

3 FRONT | Attachment Style Two
06 Scale: 1" = 1'0

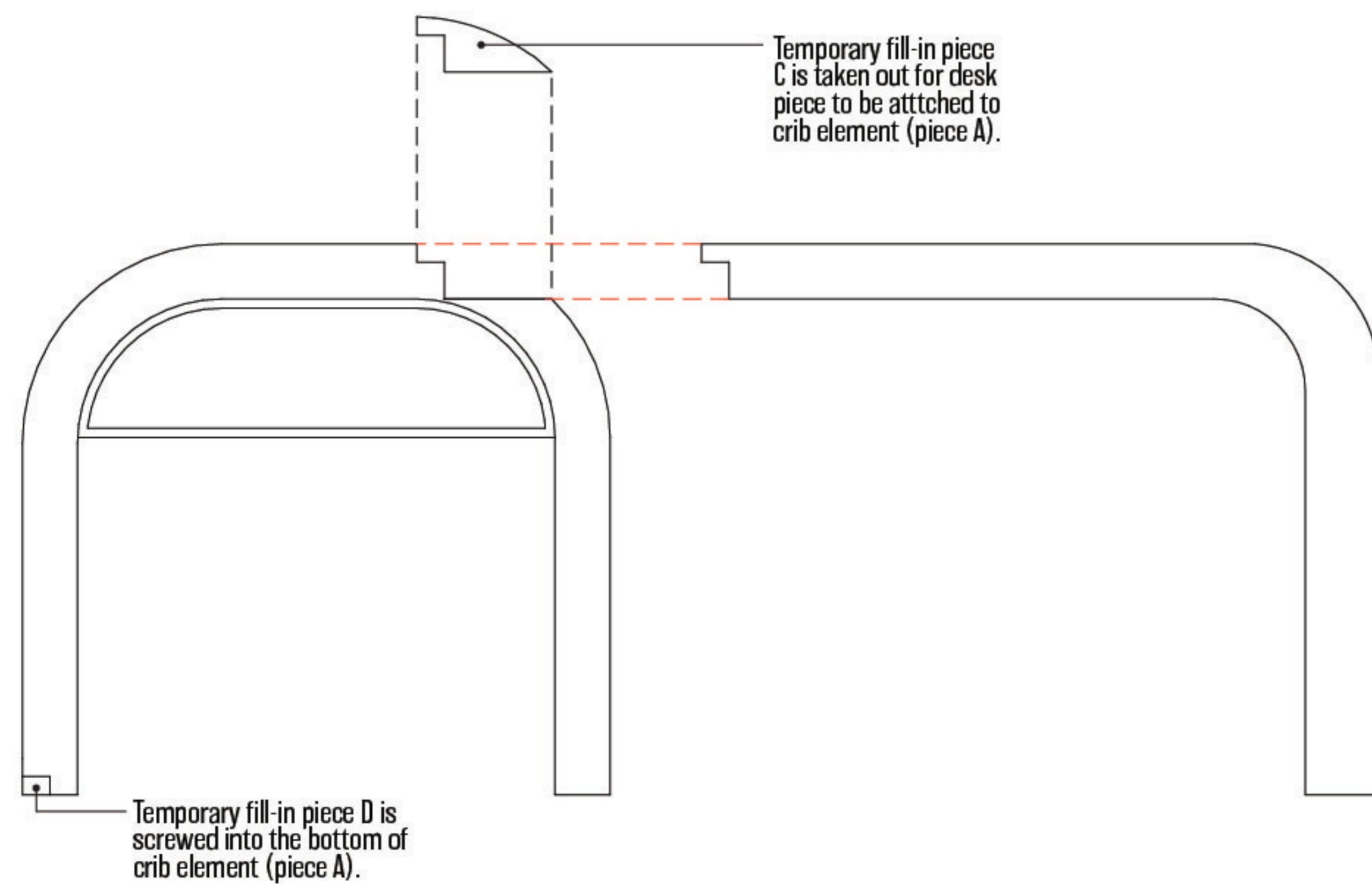

2 Attachment Style Two
06 Scale: 1" = 1'0

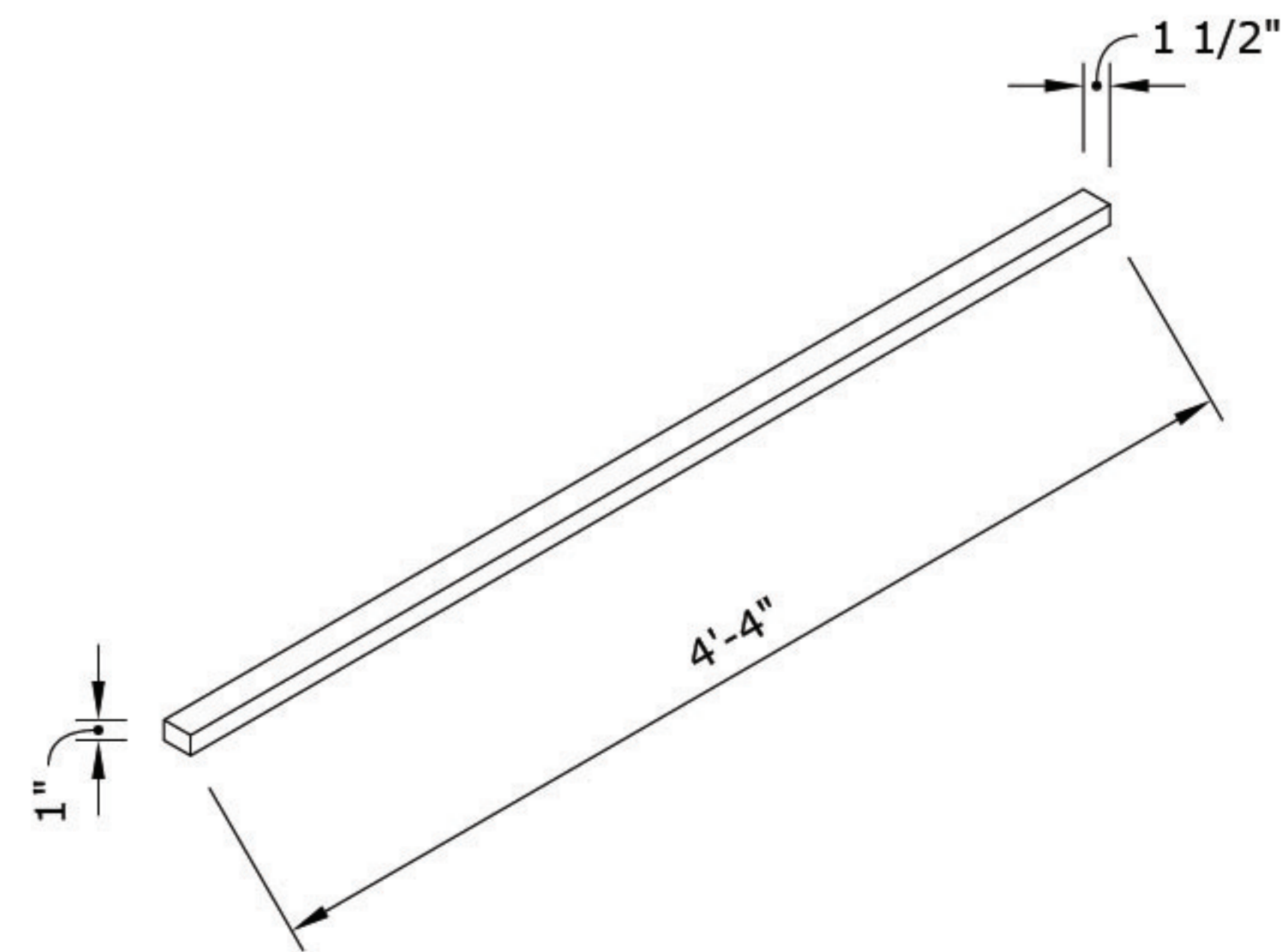

1 ISO RIGHT | Temporary Fill-In, Piece D
06 Scale: 1" = 1'0

Notes

A. Black dotted lines indicate a piece being removed. Red dotted lines indicate where pieces connect.

1. Translucent barrier panes are removed in Attachment Style Two for access to the play tunnel.

2. Fill-in pieces will need to be securely screwed in, yet still remain removable to the user, along the length of the crib (piece A). They should NOT effect the structural integrity of the overall piece, but make up for a clean silhouette when swapping between styles.

3. Fill-in pieces will have to come with predrilled holes that align with piece A for easy dis/assembly.

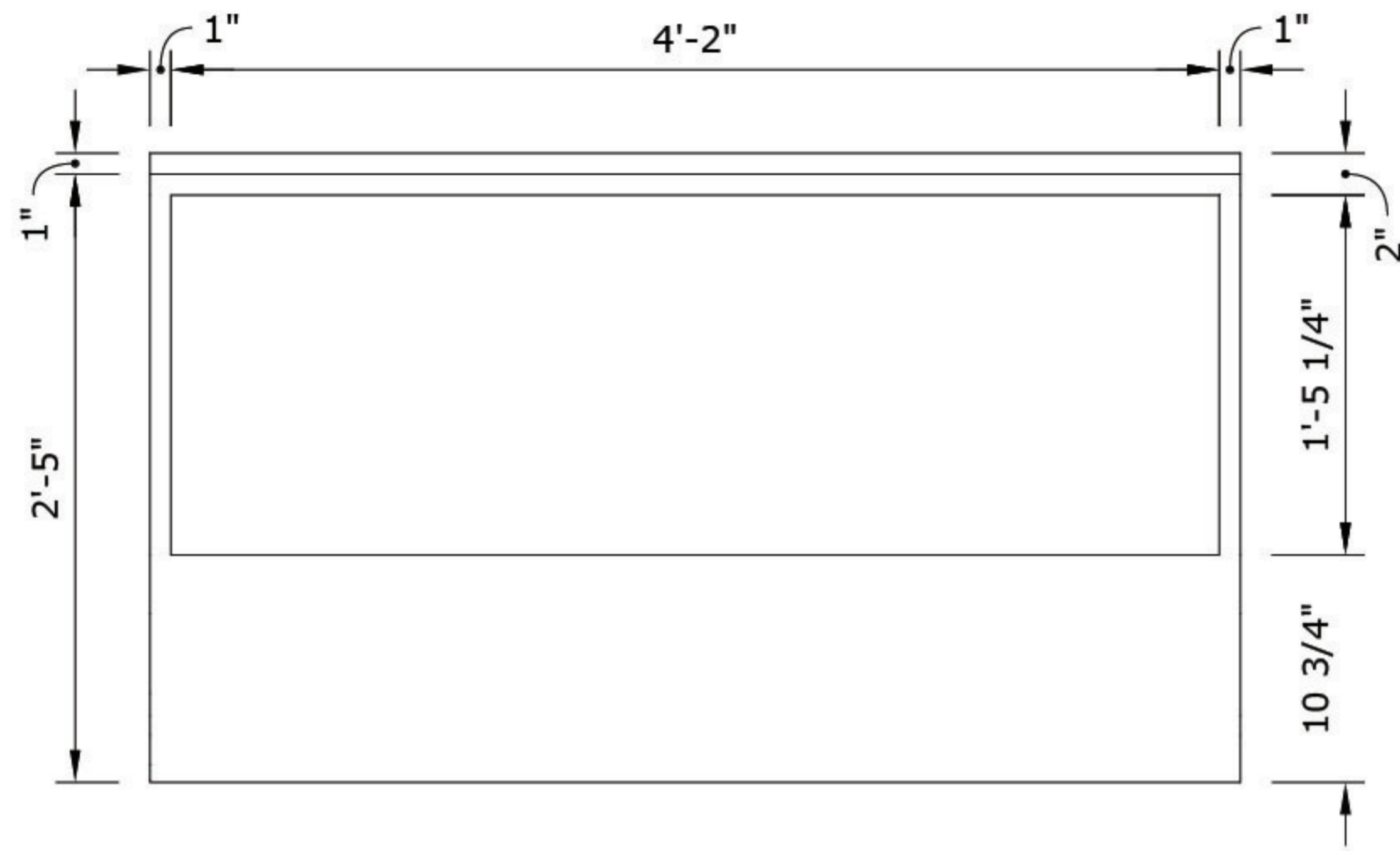

3 RIGHT | Crib, Piece A
07 Scale: 1" = 1'0

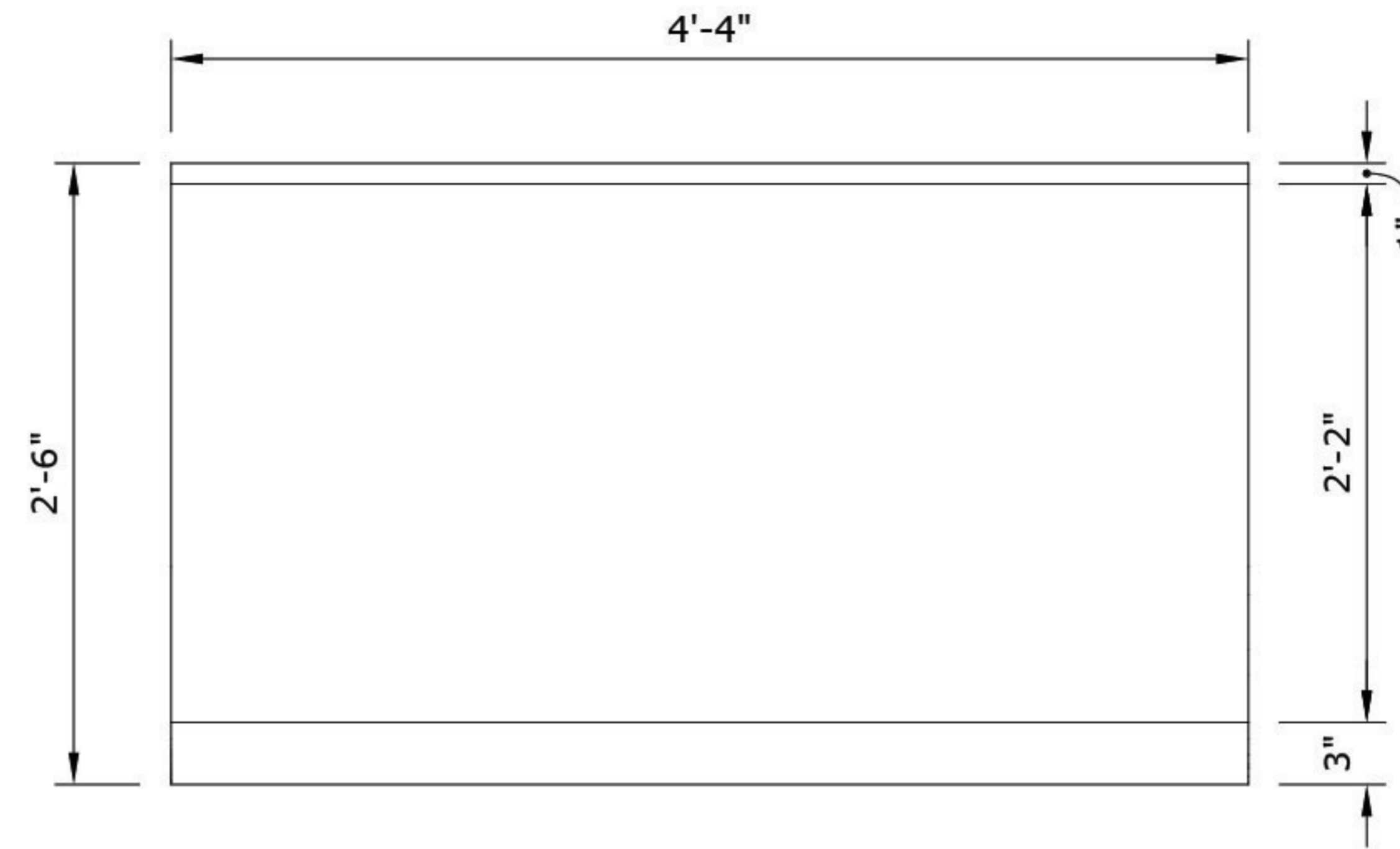

4 LEFT | Crib, Piece A
07 Scale: 1" = 1'0

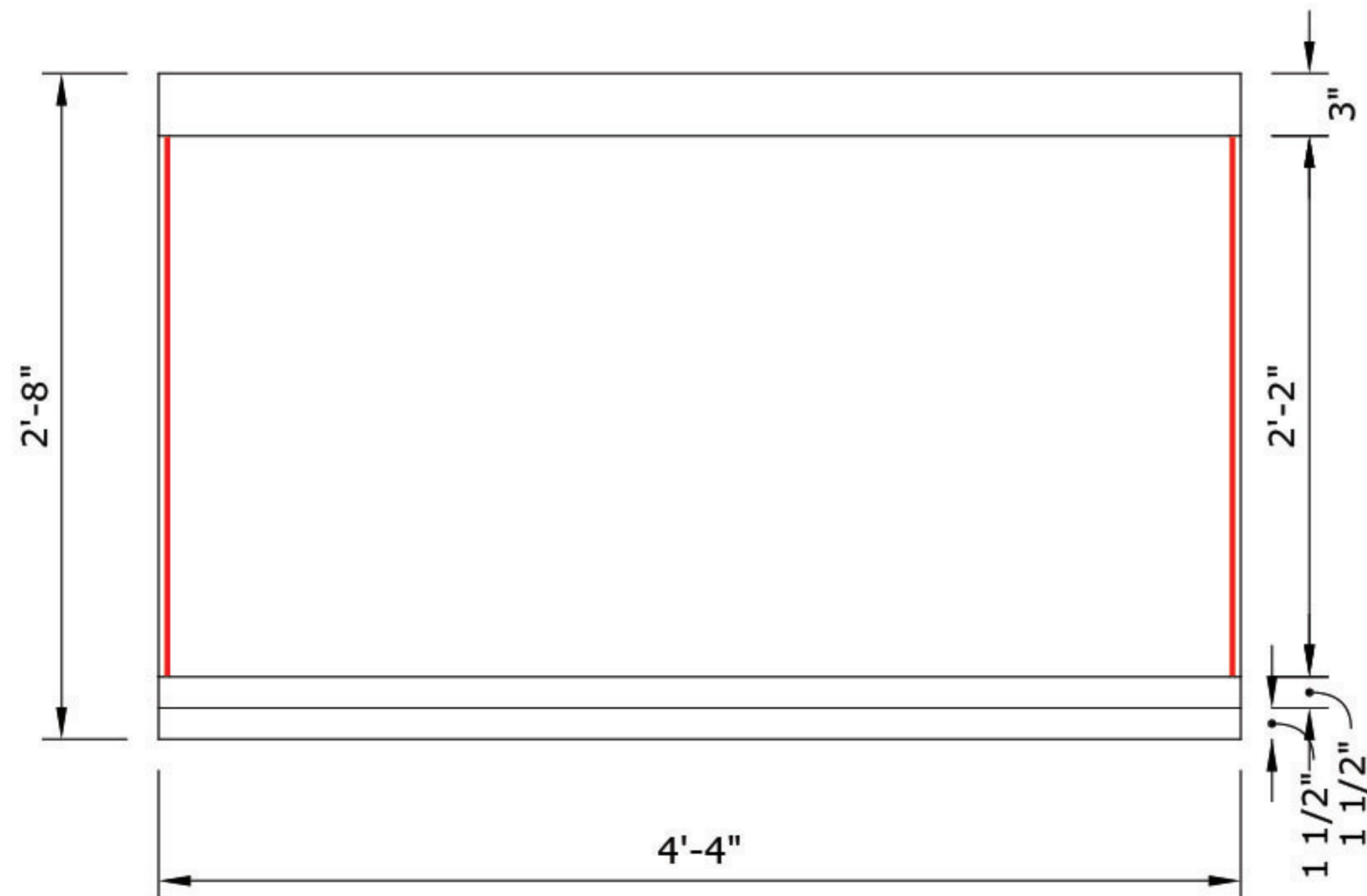

2 TOP | Crib, Piece A
07 Scale: 1" = 1'0

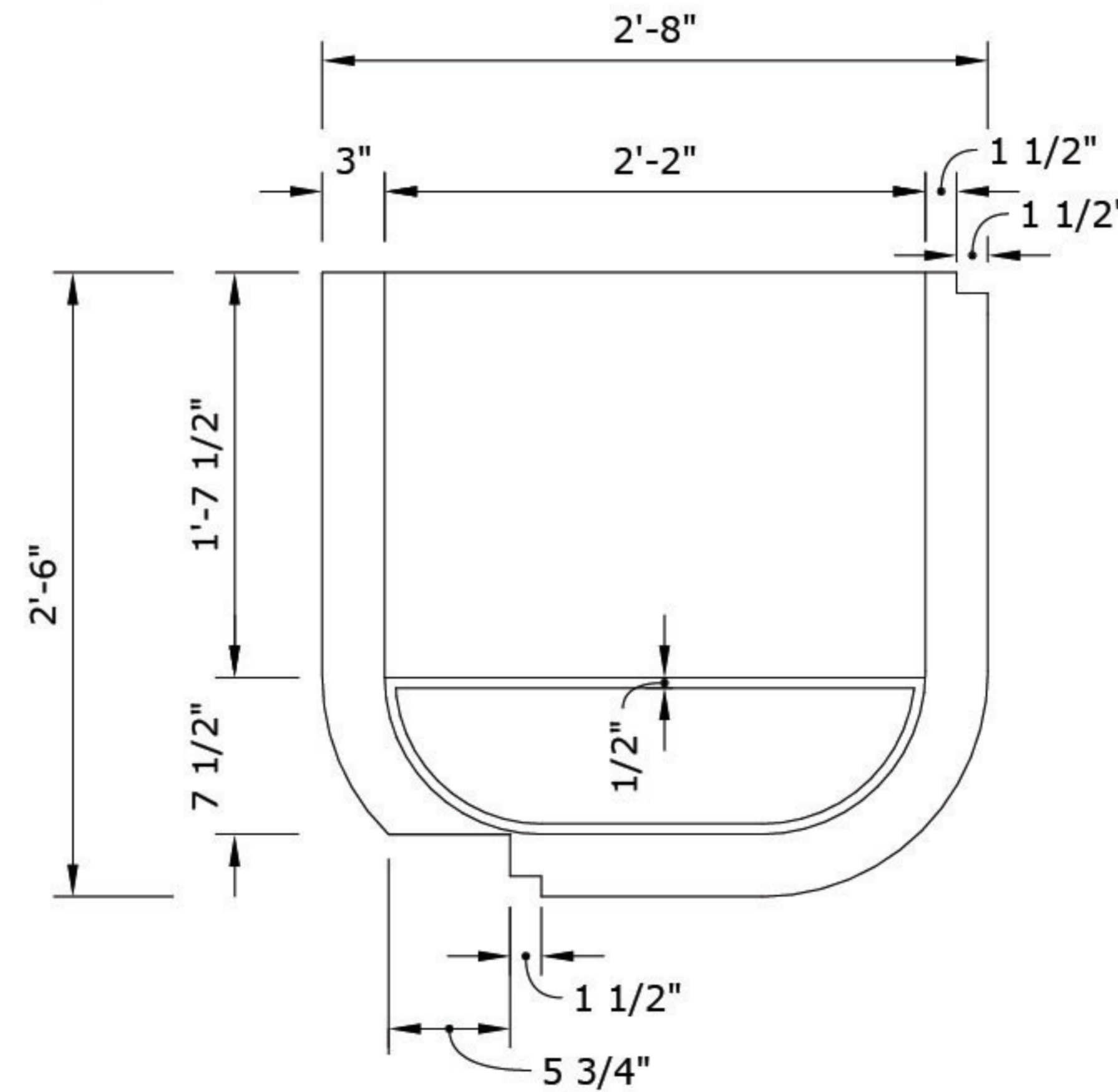

1 FRONT | Crib, Piece A
07 Scale: 1" = 1'0

Notes

1. The areas highlighted in red on the top orthographic are the proposed slot locations for the barrier panes. It is currently 1/4" wide (and 1/4" in from the edge) to snugly fit a similar width pane; the depth of this slot should be deep enough for the pane to not be able to be knocked out. This slot would have to follow along the inside walls as well for the pane to be able to slide in and out, though would not have to be as deep.

2. This piece was designed entirely with children in mind, so the function could reflect a wide range of safe, independent enrichment opportunities while still being entirely accessible for guardians to keep watch.

3. Without children, the function of this piece becomes a versatile way for the prime user to decorate or store items for their work and home space (see rendered image on page 03).

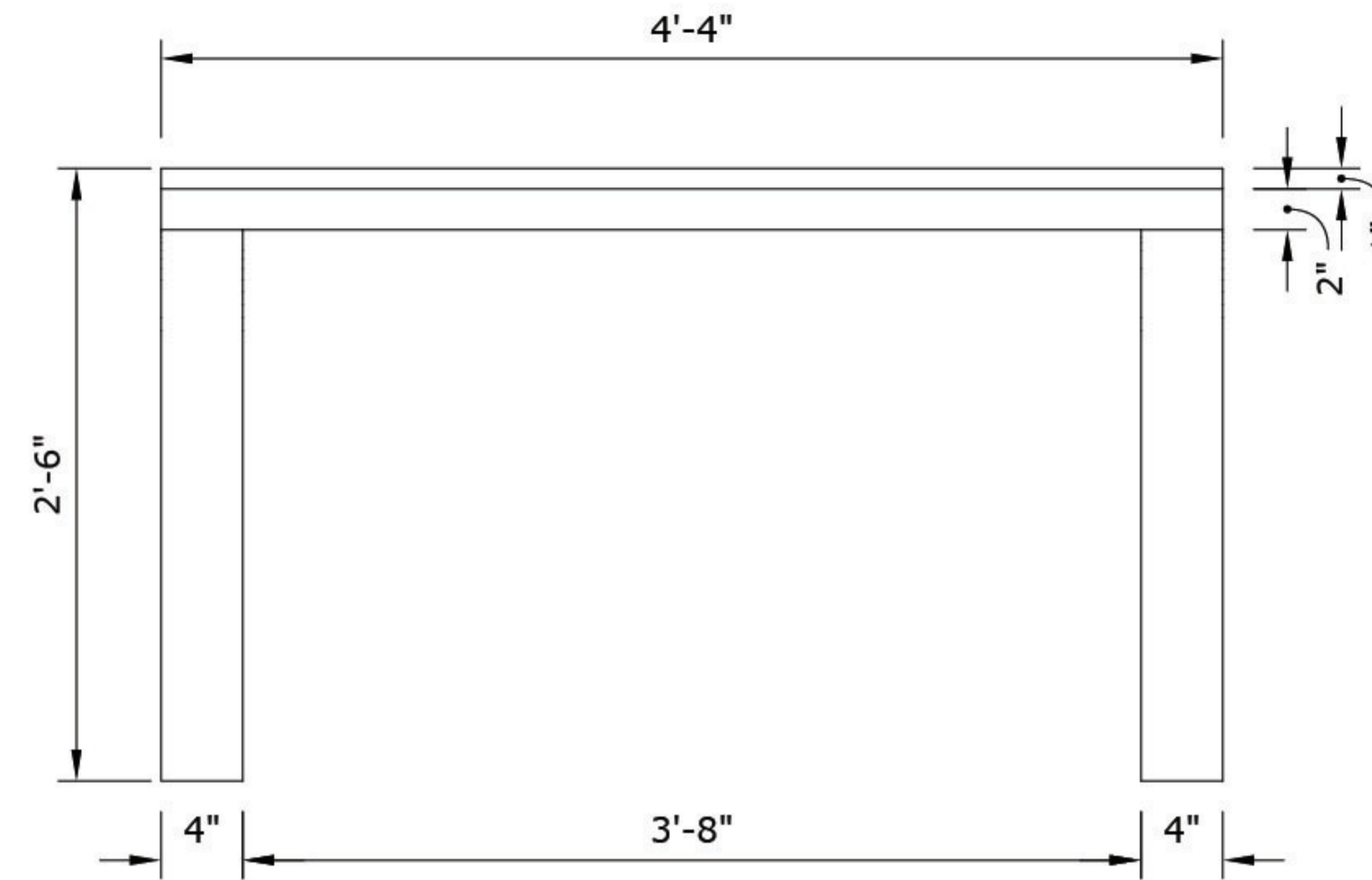
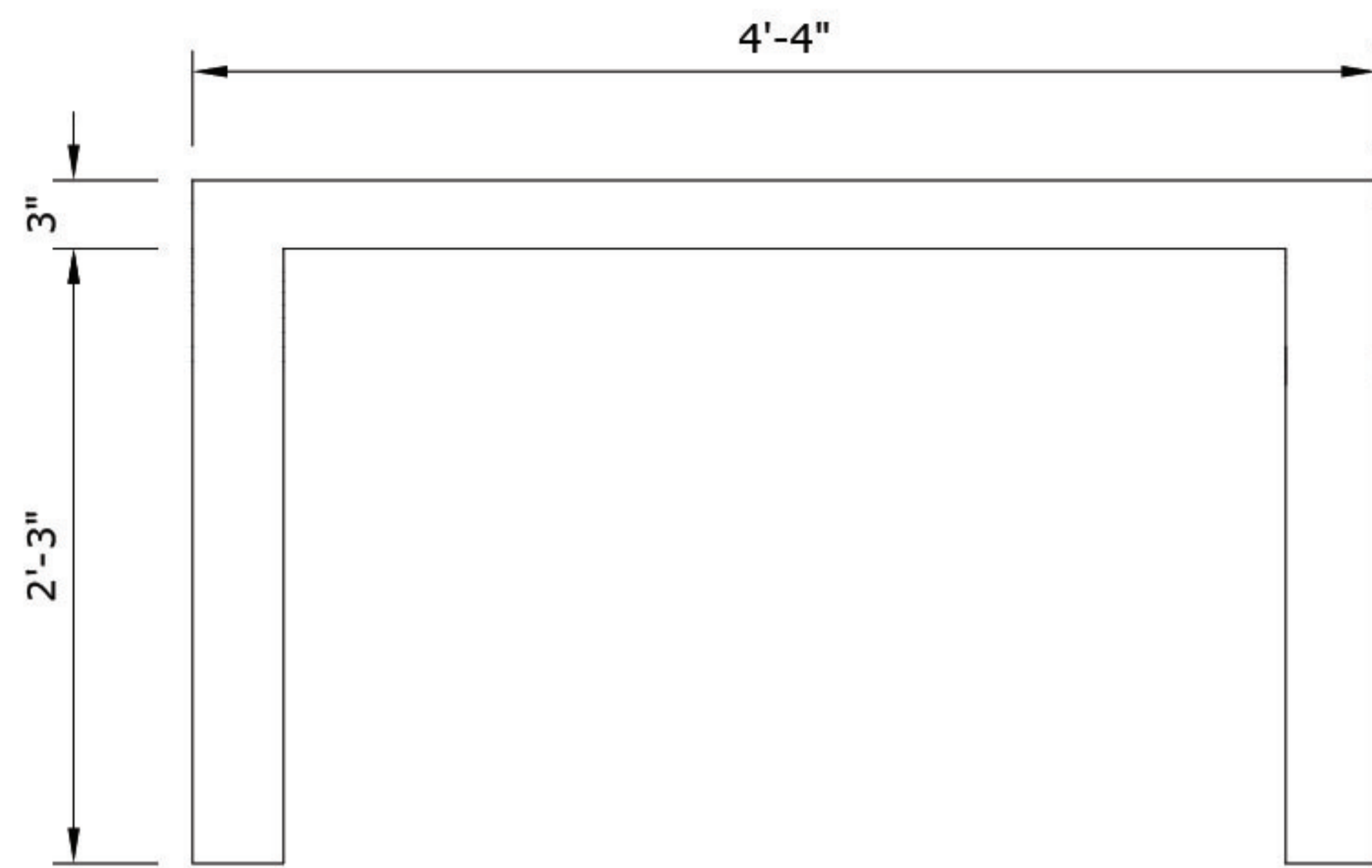

Notes

- 1. 1/2" deep gap in the desk is important to prevent objects from rolling off into areas where children will be.
- 2. Desk is not meant to be stable on it's own; piece A should fully support it's ability to stand properly.

3 RIGHT | Desk, Piece B
08 Scale: 1" = 1'0

4 LEFT | Desk, Piece B
08 Scale: 1" = 1'0

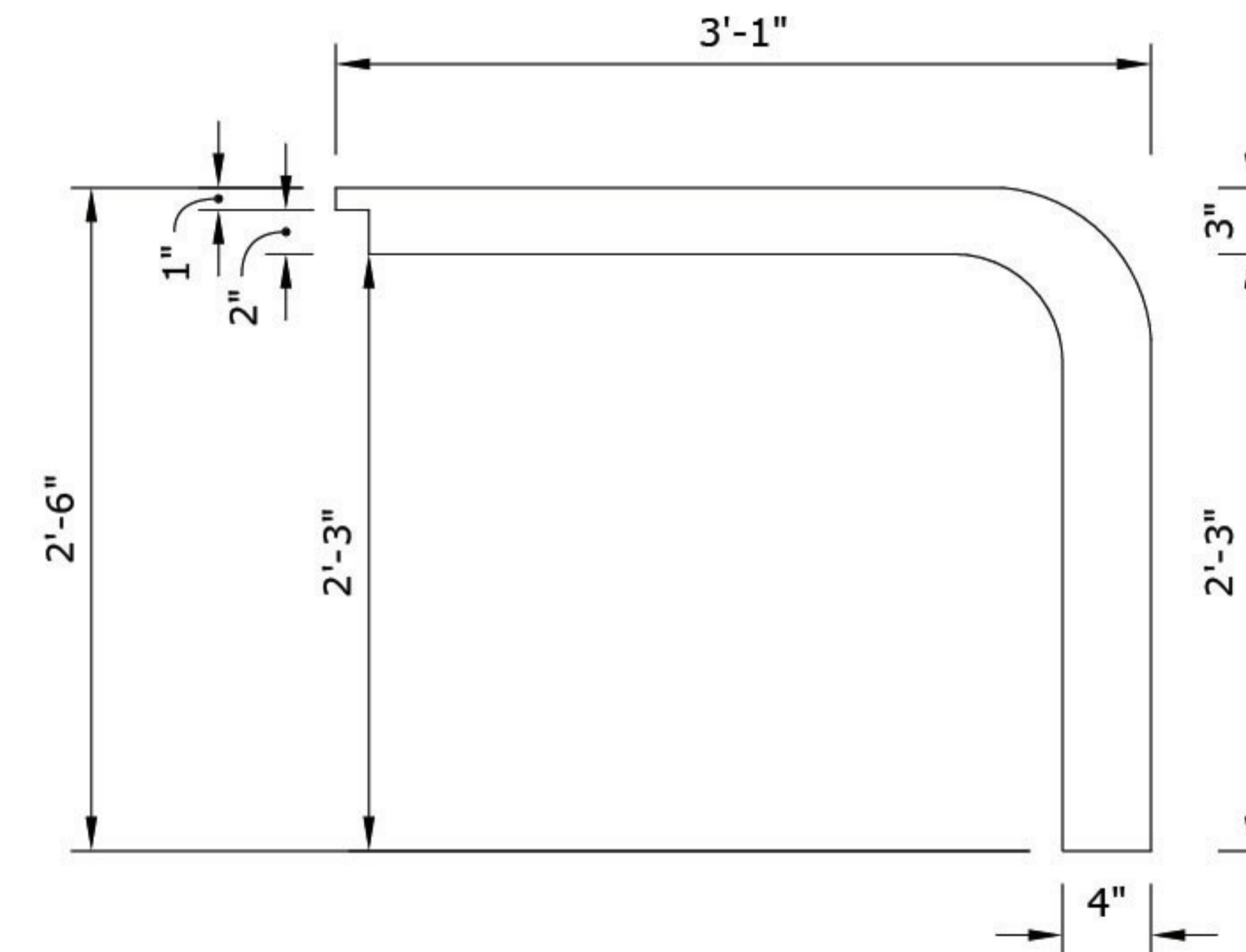
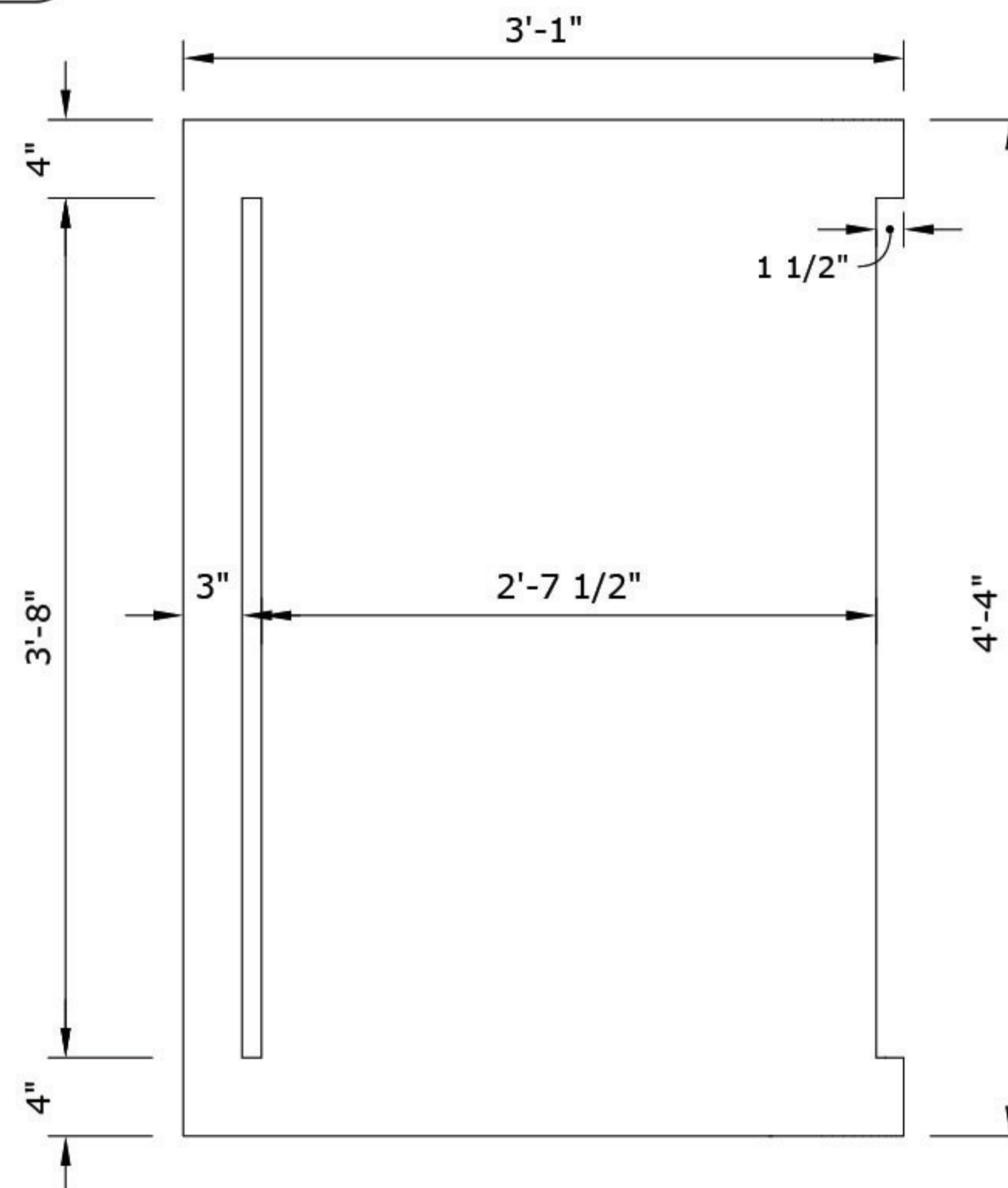

2 TOP | Desk, Piece B
08 Scale: 1" = 1'0

1 FRONT | Desk, Piece B
08 Scale: 1" = 1'0

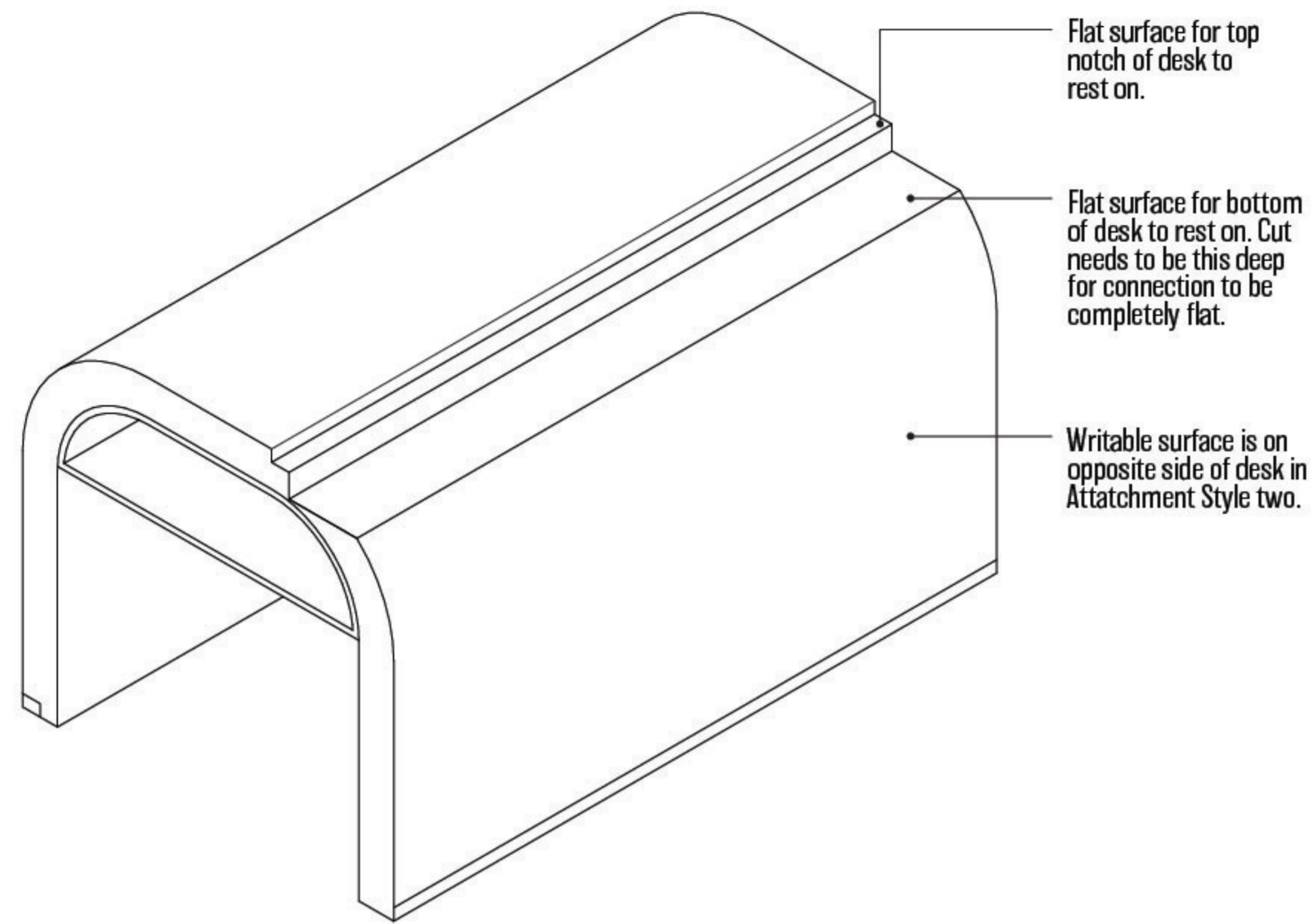

Flat surface for top notch of desk to rest on.

Flat surface for bottom of desk to rest on. Cut needs to be this deep for connection to be completely flat.

Writable surface is on opposite side of desk in Attachment Style two.

3 ISO RIGHT | Crib, Piece A, in Attachment Style One
09 Scale: 1" = 1'0

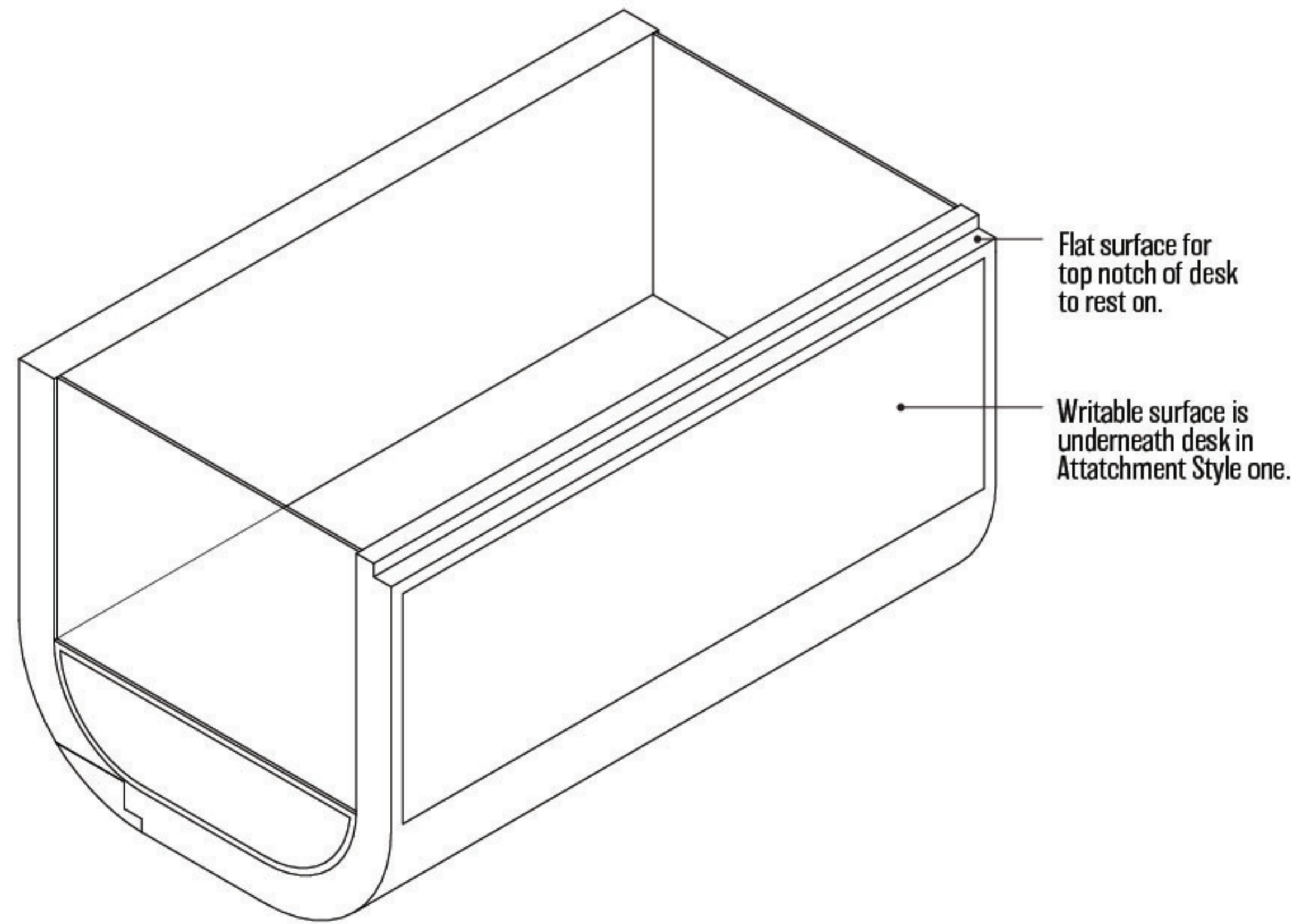

Flat surface for top notch of desk to rest on.

Writable surface is underneath desk in Attachment Style one.

2 ISO RIGHT | Crib, Piece A, in Attachment Style Two
09 Scale: 1" = 1'0

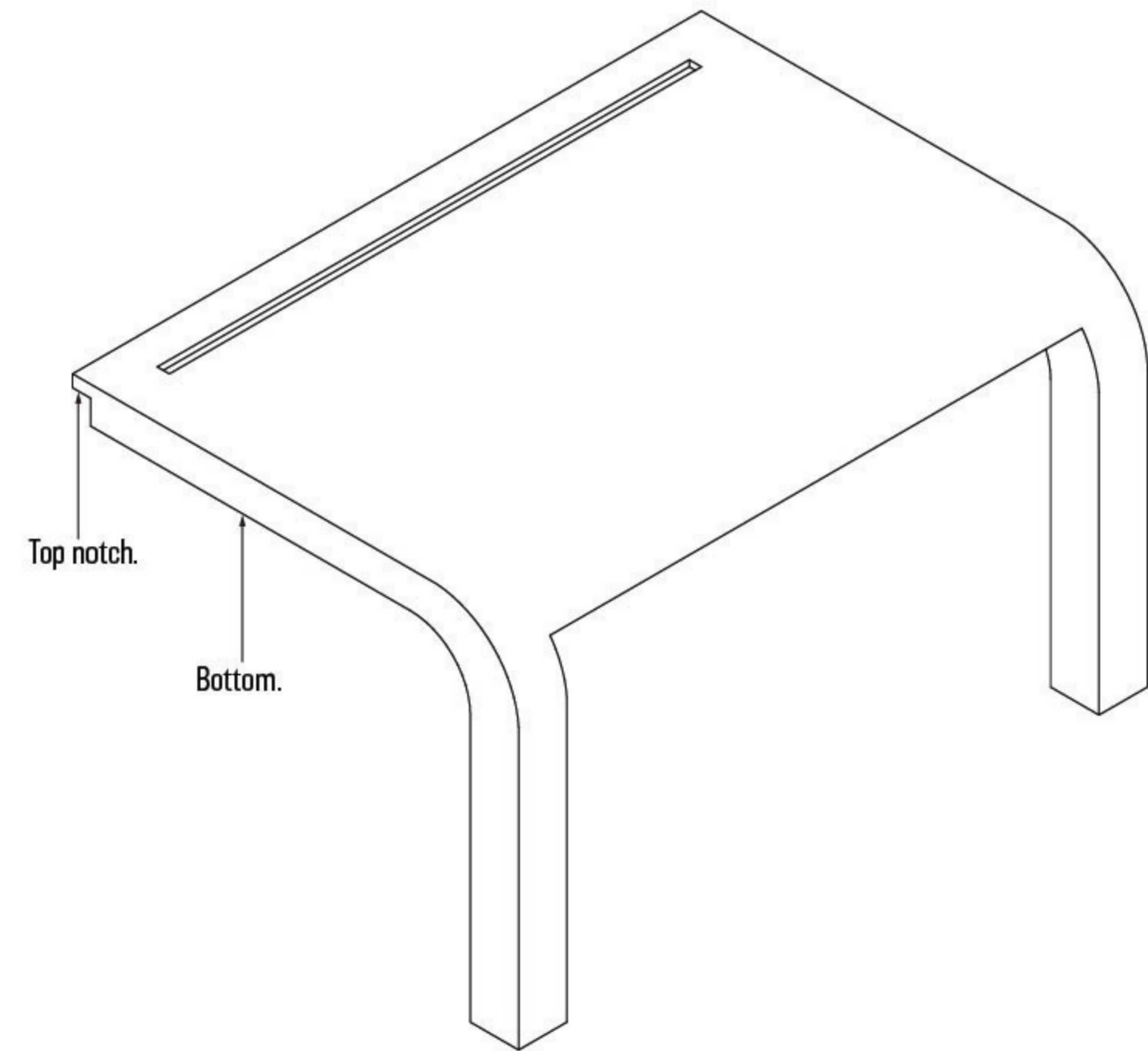

Top notch.

Bottom.

1 ISO RIGHT | Desk, Piece B
09 Scale: 1" = 1'0

Notes

1. The cutouts on piece A are fitted to snugly fit piece B in both styles so the pieces fit together without a noticeable seam.
2. Both pieces will have to come with drilled holes for simple dis/assembly. **It's important for the screws to NOT be noticeable.** Just as the fill-in pieces C and D, screws should appear seamless on the desk's surface with flat tops.